



BEVERAGE-AIR

3779 Champion Blvd., Winston-Salem, NC 27105
1-888-845-9800 Fax# 1-336-245-6453
http://www.Beverage-Air.com

CUSTOMER'S CHOICE FOR A HOT LOCATION
Tested & Certified to Ambient Class of 100°F

3 Year Parts/Labor Warranty
Additional 2 Year Compressor Warranty

MARKETMAX™ WINE MERCHANDISER

Triple section glass door wine merchandiser with Whisper-Quiet refrigeration system and lighted sign panel for merchandising and storage of bottled or boxed wine.

CABINET CONSTRUCTION

Heavy duty construction includes stainless steel interior and exterior.

Foamed-in-place CFC and HCFC-free polyurethane insulation.

Modern, one-piece grille is easily removed for cleaning and servicing.

Refrigerators have double pane, lowE argon filled glass doors. Inside and outside panes are tempered for added safety.

Spring-loaded door hinges with 120° stay-open door feature.

Anti-microbial door handles standard.

Door locks standard.

Lighted sign panel standard with optional stainless steel header panel available.

WINE RACKS

Eight (8) chrome-plated wine racks per section standard, shelf clips included (field installed).

Shelves are adjustable in 1/2" increments.

Shelves hold approximately 10-12 bottles of wine per shelf (*actual capacity will vary depending upon the diameter of bottles used*).

ELECTRONIC CONTROL

Electronic control with digital display of cabinet temperatures.

REFRIGERATION

Bottom mount, environmentally friendly refrigeration system (R134a refrigerant).

Units can be adjusted to maintain temperatures between 35°-60°F.

ELECTRICAL

Interior fluorescent lighting enhances product presentation.

Vertical interior fluorescent lighting standard with optional LED lighting upgrade available.

Standard 115/60/1 phase, 15 amp dedicated outlet required, 8' cord and plug standard.

Item No. _____
Quantity _____

HINGED GLASS DOOR
MARKETMAX™ SERIES
MMR72 Wine Merchandiser
Triple Door

MODELS:
MMR72-1-SS-WINE
MMR72-1-SS-LED-WINE

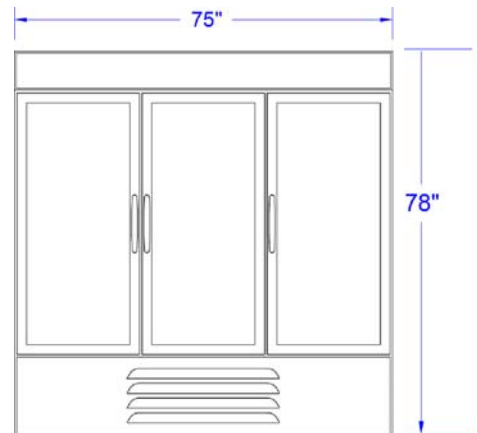

FRONT



SPECIAL FEATURES

- Whisper-Quiet refrigeration system
- Anti-microbial door handles
- Electronic control with digital display
- Snap-in door gaskets
- Brightly lighted sign panel
- Optional LED lighting
- ENERGY STAR® certification
- **Available options:** Spring Feed Dividers, Casters, Audible/Visual Alarm



Refrigerator
115/60/1
NEMA-5-15P

ELECTRICAL CONNECTION

Units pre-wired at factory and include 8' long cord and plug set.

Available From:



*Note: Not all markings may apply to all model variations.

Model Specified _____	Store# _____
Location _____	Quantity _____



PLAN VIEWS

MarketMax™ Wine Merchandiser Model: MMR72-1-SS-WINE, MMR72-1-SS-LED-WINE

MODEL	MMR72
EXTERNAL DIMENSIONAL DATA	
Length Overall (inches) Length Overall (mm)	75" 1905
Depth Overall (inches) - <i>includes handle</i> Depth Overall (mm) - <i>includes handle</i>	33 3/4" 857
Height Overall— (inches) Height Overall— (mm)	78" 1981
Number of doors	3
Depth with Door Open 90 °	55"
INTERNAL DIMENSIONAL DATA	
NET Capacity (cubic ft.) NET Capacity (Liters)	72 2039
Internal Length Overall (inches) Internal Length Overall (mm)	72" 1829
Internal Depth Overall (inches) Internal Depth Overall (mm)	28 1/2" 724
Internal Height Overall—(inches) Internal Height Overall—(mm)	61 3/4" 1569
Number of shelves	24
ELECTRICAL DATA	
Full Load Amperes	115/60/1 (9.9 A)
REFRIGERATION DATA	
Horsepower	1/3
WEIGHT DATA	
Gross Weight (Crated lbs)	715
Gross Weight (Crated kg)	324

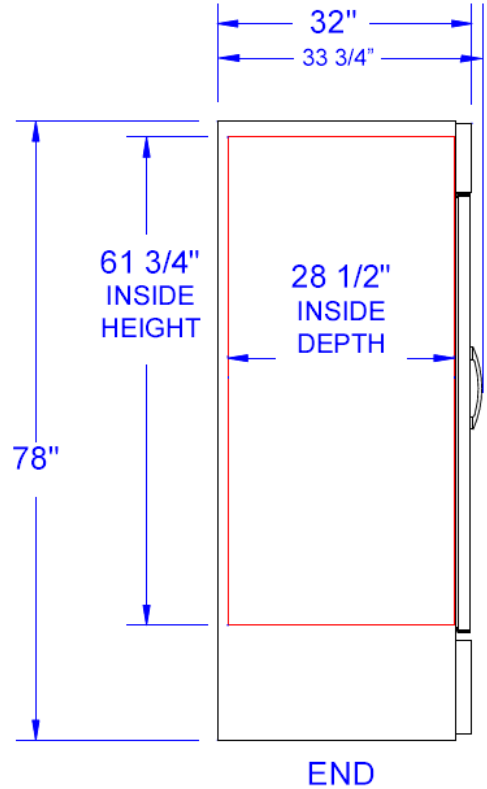

*Note: Not all markings may apply to all model variations.

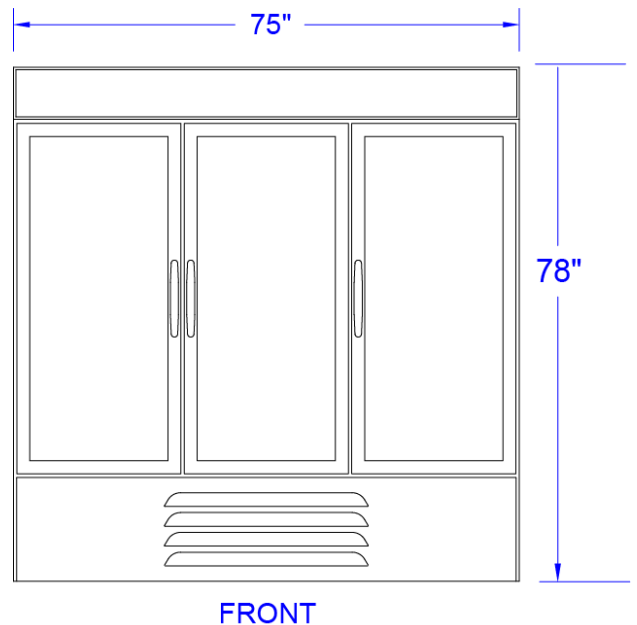
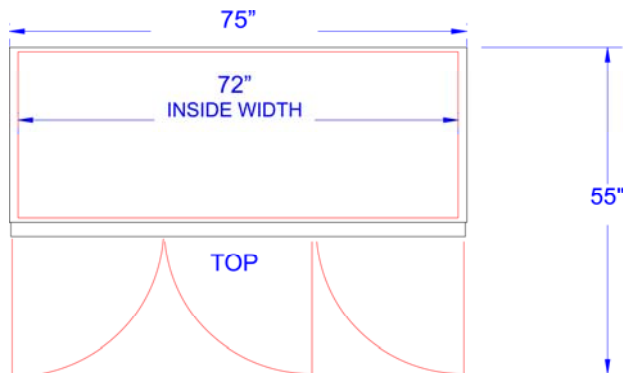

BEVERAGE-AIR® CORPORATION

3779 Champion Blvd. • Winston-Salem, NC 27105 USA • (336) 245-6400 • Fax (336) 245-6453 • (888) 845-9800 • www.beverage-air.com

Specifications are subject to change without prior notice. 03/13